

ESTÉE LAUDER

EL2323 - SP23 NICHE PERFUMERY PERMANENT

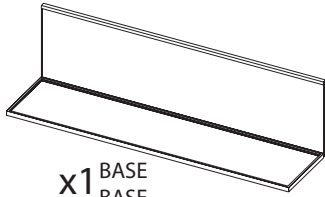

x1 BASE
BASE

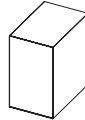

x2 BOÎTE VISUEL
VISUAL BOX



x3 PETIT VISUAL HOLDER
VISUAL HOLDER SMALL



x2 GRAND VISUAL HOLDER
VISUAL HOLDER LARGE

x2 PLOT
PLOT

①

PLACER TOUS LES ÉLÉMENTS SUR LA BASE
PLACE ALL THE ELEMENTS ON THE BASE

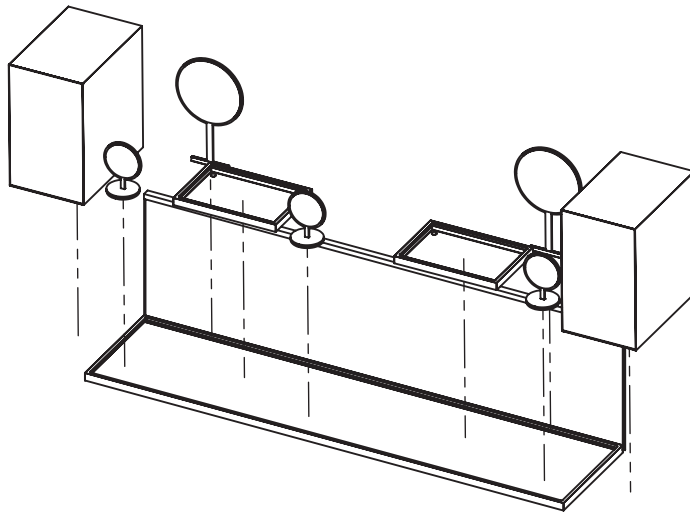

②

LES BOÎTES VISUEL PEUVENT ÊTRE PLACÉES SUR OU A CÔTÉ DE LA BASE
VISUAL BOXES CAN BE PLACED ON OR NEXT TO THE BASE

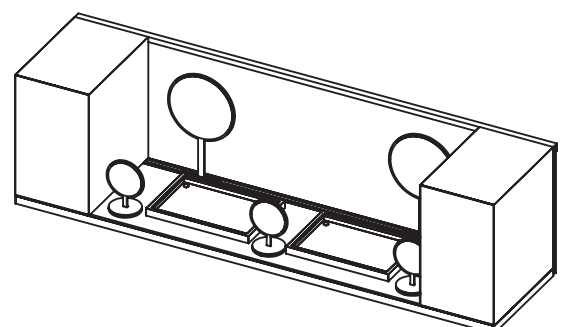
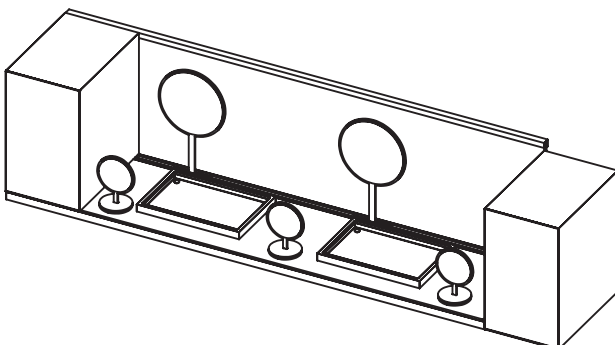
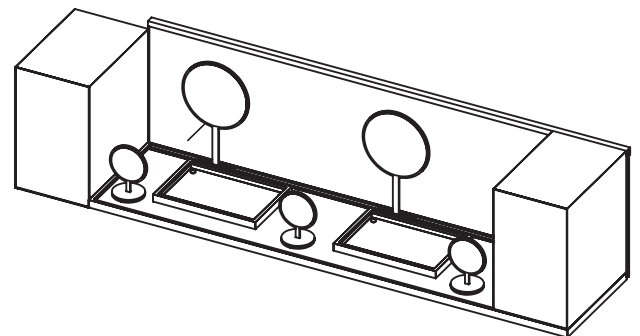
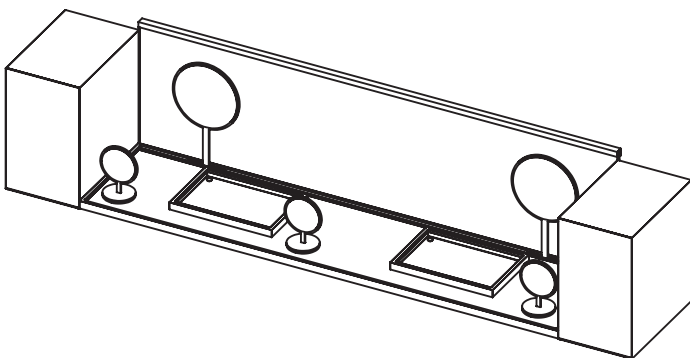

ESTÉE LAUDER

EL2323 - SP23 NICHE PERFUMERY PERMAMENT

③ CHAQUE VISUEL PEUT ÊTRE CHANGÉ EACH VISUAL CAN BE REPLACED

- ① a BASE - SOULEVEZ LA PLAQUE TRANSPARENTE ET CHANGEZ LE VISUEL
BASE - REMOVE THE TRANSPARENT PLATE AND CHANGE THE VISUAL

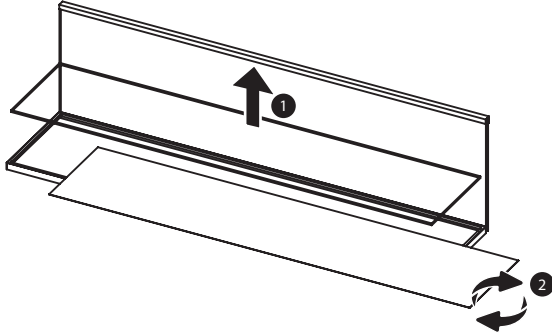

- ① b FRONTON - SOULEVEZ LA PLAQUE TRANSPARENTE ET CHANGEZ LE VISUEL
PEDIMENT - REMOVE THE TRANSPARENT PLATE AND CHANGE THE VISUAL

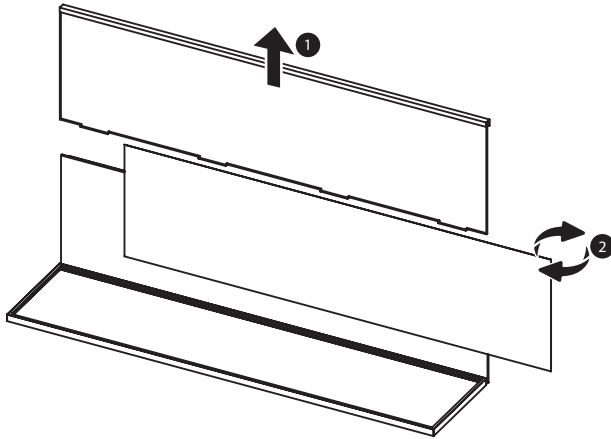

- ① c FRONTON - SOULEVEZ LA PLAQUE TRANSPARENTE ET CHANGEZ LE VISUEL
BASE - REMOVE THE TRANSPARENT PLATE AND CHANGE THE VISUAL

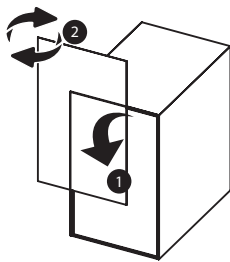

- ① d VISUAL HOLDERS - RETIREZ LE VISUEL ET PLACER LE NOUVEAU EN CLIPSANT LA CALE EN LIÈGE
VISUAL HOLDERS - REMOVE THE VISUAL AND PLACE THE NEW ONE BY CLIPPING IN THE CORK WEDGE

